

The following are the Courses & distances Down Muddy Creek from the Stone at A, to the post at B.

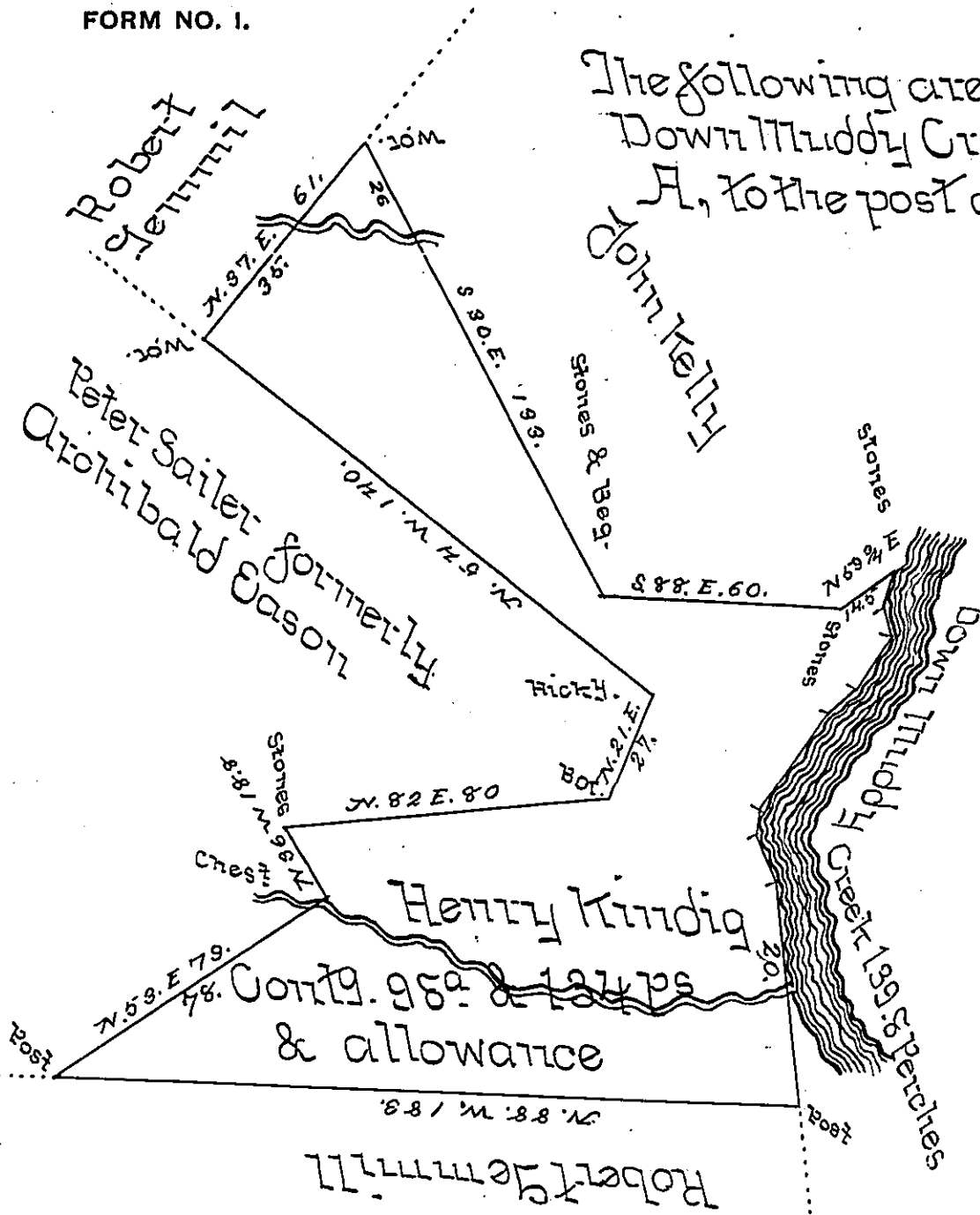

- S 27 W 8-8 Hickory Grub
  - S 33 E. 7 WOK.
  - S 36 1/4 W 14=5 post
  - S 46 W 6=7 Ches?
  - S 93 1/2 W 31 Maple
  - S 16 1/4 W 6=3 Ches?
  - S 26 E 12=5 Maple
  - S 7 1/2 E 5 1/2
- Total 199 perches & 8 tenths

Situate in Hopewell Township in the County of York containing as above set forth 98<sup>ac</sup> & 134 Perches and Allowance surveyed on the 19<sup>th</sup> day of August A.D. 1814 in Pursuance of a Warrant for 100<sup>ac</sup> granted to Henry Kindig bearing date the 28<sup>th</sup> day of August A.D. 1810.

N.B. The Improvements on the above described Land at the time of surveying were a log dwelling House some cleared Land rendering it an actual personal resident settlement with a manifest Intention of making it a place of abode and means of supporting a Family -

To Richard J. Beech Esq<sup>r</sup> } per. Jacob Spangler D.S.  
 Surveyor General  
 Harrisburg Pa -

IN TESTIMONY that the above is a copy of the original remaining on file in the Department of Internal Affairs of Pennsylvania, made conformably to an Act of Assembly approved the 16th day of February, 1833, I have hereunto set my Hand and caused the Seal of said Department to be affixed at Harrisburg, this 8<sup>th</sup> day of July 1898.

*James W. Latta*  
 Secretary of Internal Affairs.